

AGENDA MANAGEMENT SHEET

<i>Name of Committee</i>	Health Overview And Scrutiny Committee
<i>Date of Committee</i>	24 January 2007
<i>Report Title</i>	Coventry and Warwickshire Primary Care Trusts - Independent Sector Procurement
<i>Summary</i>	Gerard Dillon, Independent Sector Program Manager, to give a presentation to the Committee. A copy of the presentation is enclosed.
<i>For further information please contact:</i>	Phil Maull Senior Committee Administrator Tel: 01926 412834 philmaull@warwickshire.gov.uk

Coventry & Warwickshire Primary Care Trusts

Brief title: Independent Sector Procurement Coventry & Warwickshire PCT's

Date: January 2007

Introduction

The West Midlands Independent Sector Procurement is part of the national program for elective and diagnostic services, which will deliver a range of procedures, support further delivery of treatment in a Primary Care Setting and support meeting the maximum 18 week wait by December 2008. The program will give greater choice to both patients and referrers and introduce contestability between providers leading to improvement of services.

The procurement process is in two parts. Part one is related to diagnostic procedures that include MRI, CT, Ultrasound, Echocardiography, Audiology and Endoscopy. The second part is for elective surgical treatments from the following specialties - ENT, General Surgery, Gynaecology, Ophthalmology, Orthopaedics, Cardiology and Urology.

The contracts are initially for 5 years and will start in May and July 2007. The successful bidder for diagnostics is Mercury Health and for electives is Nuffield Hospitals.

1. Treatment Sites

Mercury Health and Nuffield hospitals have proposed a number of sites around the West Midlands region from which to deliver services. Currently the diagnostic sites proposed by Mercury Health in the Coventry area are the Ricoh Arena, Warwick University and The Courtyard Hotel and in Warwickshire the North Warwickshire and Hinckley College, Nuneaton, Rugby Football Ground, Rugby, Leamington RFC, Leamington, Moat House Inn, Alcester and subject to SHA and PCT approval Stratford Garden Centre, Stratford. Further discussions are still ongoing concerning a number of sites in Coventry.

The main site for elective procedures for both Coventry and Warwickshire PCT's will be the Warwickshire Nuffield Hospital in Leamington Spa with further discussions on the possibility of mobile sites in Coventry and North Warwickshire.

All diagnostic sites have 60-day notice get out clauses, so if for any reason the sites become unsuitable, new sites will be identified and developed.

Patients will be able to access any of the sites across the West Midlands region should they wish to once the initiative begins.

3. Engagement

A full program of engagement will take place over the coming months in the lead up to and after the launch in May and July 2007. Awareness sessions for all stakeholders are currently being arranged and will be delivered through presentations or reporting processes with input from both providers.

The development of referral pathways is underway at regional level that will enable direct access to diagnostic testing from primary care in order to support the move toward the 18 weeks referral to treatment target. Fine-tuning of the pathway will be undertaken locally to ensure it will meet the needs of local clinicians.

4. Risks and Payment

The diagnostic and elective numbers were calculated on the basis of DoH guidelines regarding the suggested number of scans per head of PCT responsible population and the level of elective surgery to be undertaken by the independent sector. In addition the values were submitted at a point in time when waiting times for diagnostic and elective surgery was significantly longer than currently is the case.

There is a risk that the diagnostic capacity commissioned by the DoH will not be required as waiting times have reduced significantly resulting in the potential for under utilisation of the mobile facilities. There is a further risk that patients will not choose to use the independent sector (via the CHOICE process) for either element of the procurement.

However if patients were to opt to use the procured services then this may impact on service use at South Warwick and George Eliot Acute Trusts and the affordability of the PFI hospital.

The DoH has underwritten costs associated with the capital element of the mobile solution, however revenue costs are on the basis of 'pay as you go' and are at tariff prices. Therefore the PCT will only pay per treatment as per Payment by Results and not as in previous IS contracts, where the provider was paid regardless of activity or patient access to services.

Coventry and Warwickshire PCT Independent Sector Procurement Programme:

Diagnostics and Elective Services

January 2007
Gerard Dillon



Procurement Support Team

- Roy Williams Commissioning Manager Coventry PCT
- Gerard Dillon Independent Sector Program Manager Coventry & Warwickshire PCT's
- Beverley Sandy Mercury Health Locality Lead
- Andrew Whithorn & Edward Goldsmith Nuffield Hospitals



Introduction

- Introduction to IS Programme
- Service Delivery Locations
- Treatment Sites
- Mobile Units
- Service Model
- Engagement
- Benefits
- Contact Details



Introduction to the Programme

- National Program West Midlands Independent Sector Procurement
- Procurement process in two parts, diagnostic and elective services to sit within locally agreed Patient Care Pathways
- Diagnostics services to include Magnetic Resonance Imaging (MRI) & Computerised Tomography (CT) Scans, Ultrasound, Echocardiography, Audiology and Endoscopy
- Elective services includes day case surgery for the following specialities, Ear Nose and Throat (ENT), General Surgery, Trauma & Orthopaedics, Gynaecology, Ophthalmology, Urology, Cardiology, General Medicine & Oral Surgery



Introduction to the Programme

- Supports Government commitment to:
 - *Shift to Primary Care*
 - *Providing for a maximum 18 week wait by 2008*
 - *Patient Choice*
- The Independent Sector (IS) will provide only a small proportion of the total growth in diagnostics and elective required to meet the above
- Diagnostic services provided by Mercury Healthcare
- Elective services provided by Nuffield Hospitals
- A legally binding contract running for 5 years
- Available to all referrers (GP, Consultants, Physio's etc) using current referral methods



Introduction to the Programme

- Pay as you go contract
- IS working relationships
- Clinical Specifications developed and agreed in conjunction with the National Clinical Leads
- Workforce (HR) policies agreed in conjunction with the Workforce Directorate of the Department of Health and where appropriate Unions
- Detailed Care Pathways are under development with local clinicians to fit local requirements



Treatment Sites

- Diagnostic sites confirmed for Coventry: North - Ricoh Arena, South West - Warwick University, South East – Courtyard Hotel
- Diagnostic sites confirmed for Warwickshire: Nuneaton, Rugby, Leamington Spa, Alcester and Stratford-Upon-Avon
- Further sites to be agreed
- 60 day get out clause
- Elective site confirmed for Coventry and Warwickshire: Nuffield Hospital Leamington Spa
- Discussion on sites in Coventry and North Warwickshire
- Patient access to all West Midland sites

Mobile Units

- Typically, a mobile diagnostic centre (MDC) will consist of 3 vehicles which are linked together on site
- MDC's will travel from each site and be set up overnight
- All MDC's are completely self sufficient requiring no power, water etc
- A MDC will provide reception, patient and staff facilities, consultation rooms, changing rooms, modality specific equipment

Mobile Diagnostic Centres

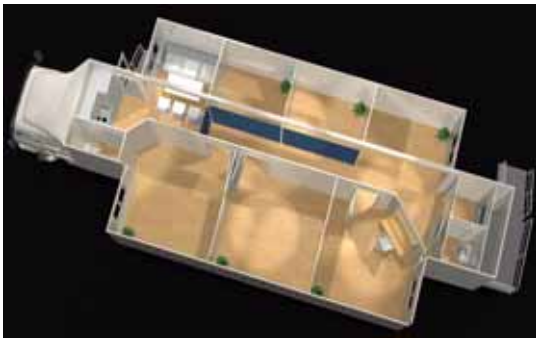

MDC - Endoscopy



What it will feel like.....

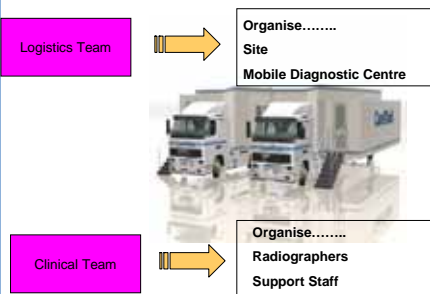

Service Model

- Referrals can come by Choose And Book, Email or paper format to suit our local needs
- Diagnostic tests will be carried out within 10 working days of accepting a referral and a report will be provided within 2 working days to the referrer
- Opening times 8am 8pm Monday - Saturday
- Information Management & Technology, referral pathways and clinical engagement taking place to meet local needs

Engagement

- Detailed communication & engagement plan
- Project board – SHA & local health economy
- Mercury and Nuffield involvement
- Information Management & Technology, referral pathways and clinical engagement sub groups
- Referrer training and awareness
- Briefings and awareness sessions
- Media
- Marketing Material



Benefits

- Local access in Primary Care setting
- Shorter waits for treatment
- Extended Choice
- Parking
- Direct access for GP's
- Quick results
- CaB
- Contract pay as you go
- 18 week targets
- Appropriate treatment in Primary Care



Contact Information

Roy Williams Email: roy.williams@coventrypct.nhs.uk
Tel: 024 7624 6038

Gerard Dillon Email: gerard.dillon@warkpct.nhs.uk
Tel: 01788 513027

West Midlands Independent Sector Diagnostics Web page:
<http://www.enet.westmidlands.nhs.uk/Independent%20Sector>



Acronyms

IS – Independent Sector
MRI- Magnetic Resonance image
CT – Computerised Tomography
ENT – Ear, Nose & Throat
PCT – Primary Care Trust
GP – General Practitioner
MDC – Mobile Diagnostic Unit
SHA – Strategic Health Authority
CaB – Choose and Book

